

# AVD Drill Head 'P' For Mirow Chuck

Last Rev. September 2013

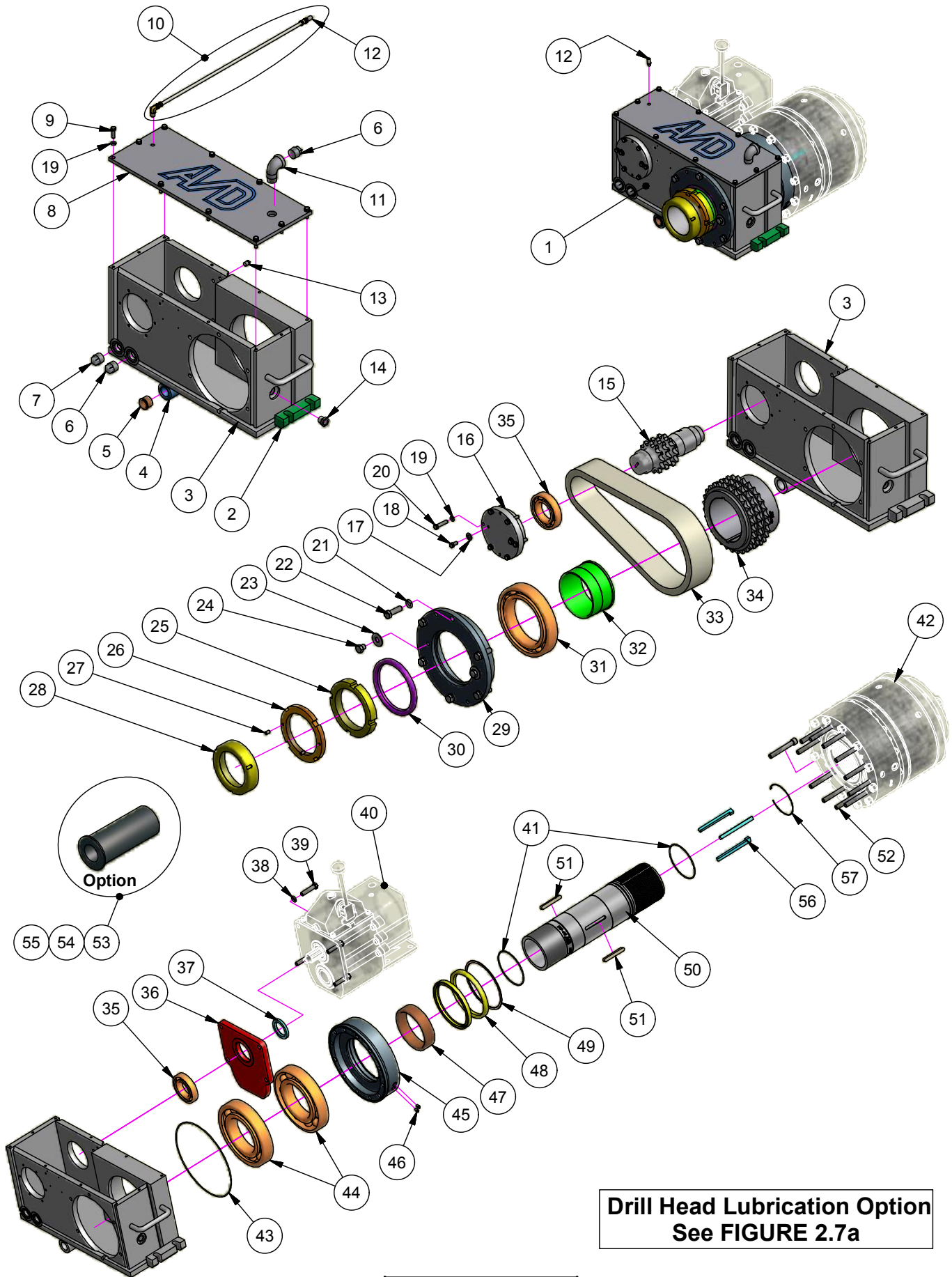

**Drill Head Lubrication Option  
See FIGURE 2.7a**

**FIGURE 2.7**

**FIGURE 2.7: AVD Drill Head 'P' For Mirow Chuck**

ITEM #	PART#	QTY	DESCRIPTION
1	DHP-M	1	Drill Head Assembly (Only DH-26 Included & DH-46 Not Included )
2	DH-40HD	1	Swing Bolts Holder (Included in DHP-1)
3	DHP-1	1	Drill Head Casing (DHP-40HD & DH-35 Included)
4	DH-35	1	Drill Head Casing Hinge Body (Included in DHP-1)
5	DH-36	2	Drill Head Casing Hinge Bushing
6	SQHP1NPT	2	Square Head Plug Ø1" NPT
7	SQHP1NPT-M	1	Magnetic Square Head Plug Ø1" NPT
8	DHP-25	1	Drill Head Casing Cover
9	HHCS38C114	10	Hex Cap Screw Ø3/8" UNC x 1 1/4"
10	DH-46	1	Breather And Extension Kit c/w DH-26
11	BPBE90AC1000	1	Steel Elbow 1" - 90°
12	DH-26	1	Drill Head Casing Relief Valve (IN ONLY)
13	SQHP14NPT	1	Square Head Plug Ø1/4" NPT
14	WSGP34NPT	1	Window Sight Glass Plug Ø3/4" NPT (Oil Level)
15	DH-30	1	Drill Head Sprocket (12 Teeth)
16	DH-33	1	Drill Head Sprocket Bearing Cap
17	W38	2	Washer 3/8"
18	HHCS38C34	2	Hex Cap Screw Ø3/8" UNC x 3/4"
19	LW38	16	Lock Washer 3/8"
20	HHCS38C134	6	Hex Cap Screw Ø3/8" UNC x 1 3/4"
21	LW58	6	Lock Washer 5/8"
22	HHCS58C2	6	Hex Cap Screw Ø5/8" UNC x 2"
23	W58	2	Washer 5/8"
24	DHP-17	2	Hex Cap Screw Ø5/8" UNC x 5/8" (Modified)
25	DHP-11	1	Spindle Adjustment Nut
26	DHP-12	1	Spindle Locking Nut
27	SS38C58	2	Set Screw Ø3/8" UNC x 5/8"
28	DHP-13	1	Drill Head Lower Spindle Cap Nut
29	DHP-8	1	Drill Head Lower Spindle Retaining Ring
30	OSEAL210863394	1	Drill Head Lower Spindle Oil Seal (Garlock 21086 3394)
31	BEA6032	1	Bearing 6032-M-C3
32	DHP-6	1	Drill Head Spindle Sleeve
33	DHP-31-29	1	Drill Head Chain 'P' Head (50 Pins)
34	DHP-2-29	1	Drill Head Hollow Sprocket
35	BEA6213C3E	2	Bearing NSK 6213C3E
36	DH-21	1	Drill Head To Transmission Adaptor
37	OSEAL473243	1	Drill Head To Transmission Oil Seal 473243
38	LW916	4	Lock Washer 9/16"
39	HHCS916C212	4	Hex Cap Screw Ø9/16" UNC x 2 1/2"
40	TR	1	Funk Transmission (SEE FIGURE 2.8)
41	ORING2-254	2	O-Ring 2-254
42	CHKP-M	1	Mirow 'P' Chuck Assembly (SEE FIGURE 2.10)
43	ORING2-278	1	O-Ring 2-278
44	BEA7230	2	Thrust Bearing 7230-B-MP-UA
45	DHP-16M	1	Drill Head Upper Spindle Retaining Ring (For Mirow 'P' Chuck) c/w WH-800 & ORING2-278
46	Z18	2	HYD Grease Fitting Ø1/8" NPT
47	DHP-38M	1	Drill Head Upper Spindle Seal Bushing (For Mirow 'P' Chuck)
48	OSEAL210863492	2	Drill Head Upper Spindle Oil Seal (Garlock 21086 3492)
49	WH-800	1	Internal Spiral Ring
50	DHP-3M	1	Drill Head Spindle Tube For Mirow 'P' Chuck
51	DH-4	2	Drill Head Spindle Tube Key (For DHP-2-29 - Sprocket)
52	SHCS58C412	12	Socket Head Cap Screw Ø5/8" UNC x 4 1/2"
53	DHP-43	1	'N' Rod Adaptor For 'P' Head
54	DHP-44	1	'B' Rod Adaptor For 'P' Head
55	DHP-45	1	'H' Rod Adaptor For 'P' Head
56	CHKP-28	3	Mirow 'P' Chuck Key
57	CHKP-29	1	Mirow 'P' Chuck Key Locking Spring

# AVD Drill Head 'P' For Mirow Chuck

Last Rev. September 2013

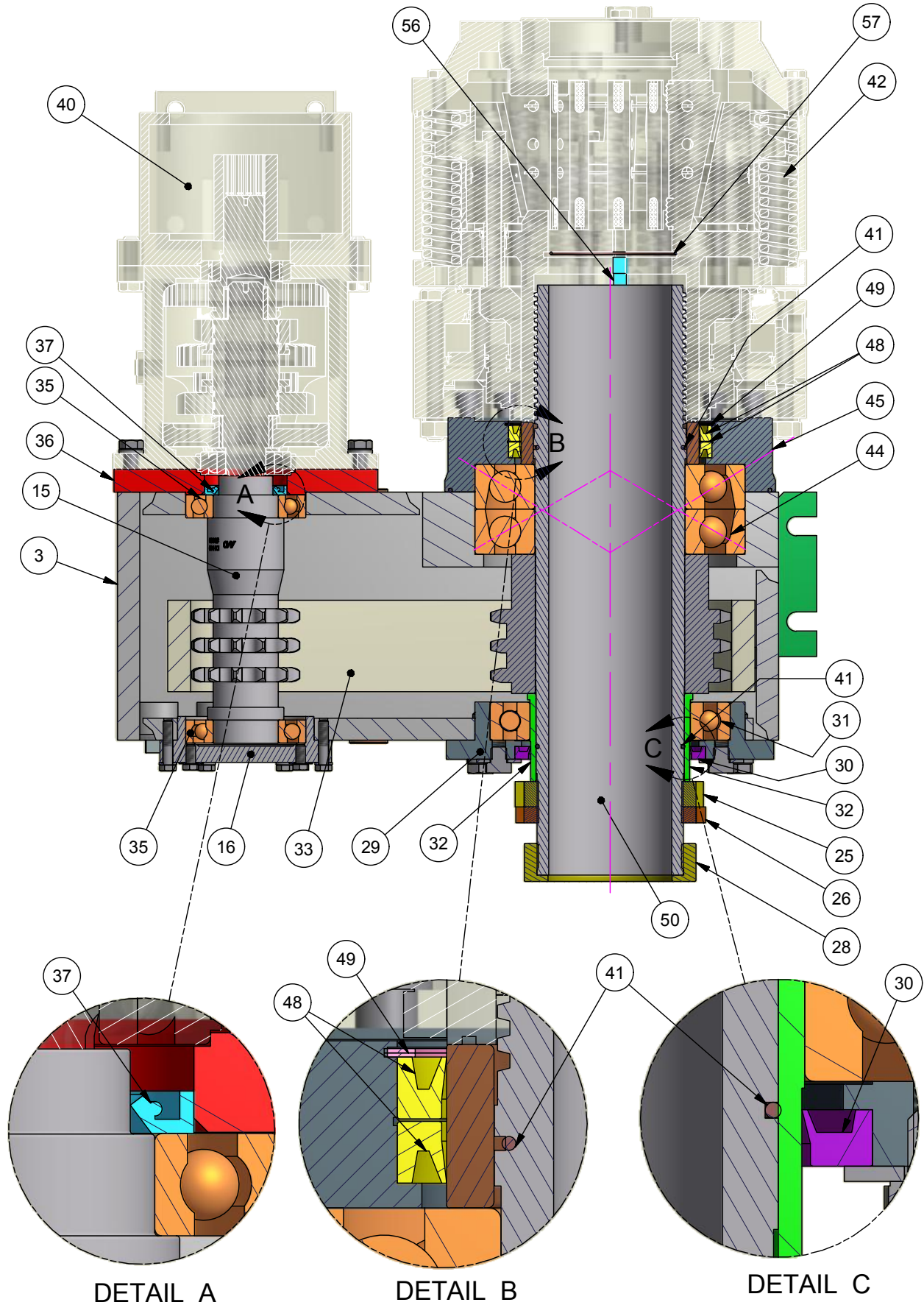

**FIGURE 2.7 - SECTION VIEW**

**FIGURE 2.7: AVD Drill Head 'P' For Mirow Chuck**

ITEM #	PART#	QTY	DESCRIPTION
1	DHP-M	1	Drill Head Assembly (Only DH-26 Included & DH-46 Not Included )
2	DH-40HD	1	Swing Bolts Holder (Included in DHP-1)
3	DHP-1	1	Drill Head Casing (DHP-40HD & DH-35 Included)
4	DH-35	1	Drill Head Casing Hinge Body (Included in DHP-1)
5	DH-36	2	Drill Head Casing Hinge Bushing
6	SQHP1NPT	2	Square Head Plug Ø1" NPT
7	SQHP1NPT-M	1	Magnetic Square Head Plug Ø1" NPT
8	DHP-25	1	Drill Head Casing Cover
9	HHCS38C114	10	Hex Cap Screw Ø3/8" UNC x 1 1/4"
10	DH-46	1	Breather And Extension Kit c/w DH-26
11	BPBE90AC1000	1	Steel Elbow 1" - 90°
12	DH-26	1	Drill Head Casing Relief Valve (IN ONLY)
13	SQHP14NPT	1	Square Head Plug Ø1/4" NPT
14	WSGP34NPT	1	Window Sight Glass Plug Ø3/4" NPT (Oil Level)
15	DH-30	1	Drill Head Sprocket (12 Teeth)
16	DH-33	1	Drill Head Sprocket Bearing Cap
17	W38	2	Washer 3/8"
18	HHCS38C34	2	Hex Cap Screw Ø3/8" UNC x 3/4"
19	LW38	16	Lock Washer 3/8"
20	HHCS38C134	6	Hex Cap Screw Ø3/8" UNC x 1 3/4"
21	LW58	6	Lock Washer 5/8"
22	HHCS58C2	6	Hex Cap Screw Ø5/8" UNC x 2"
23	W58	2	Washer 5/8"
24	DHP-17	2	Hex Cap Screw Ø5/8" UNC x 5/8" (Modified)
25	DHP-11	1	Spindle Adjustment Nut
26	DHP-12	1	Spindle Locking Nut
27	SS38C58	2	Set Screw Ø3/8" UNC x 5/8"
28	DHP-13	1	Drill Head Lower Spindle Cap Nut
29	DHP-8	1	Drill Head Lower Spindle Retaining Ring
30	OSEAL210863394	1	Drill Head Lower Spindle Oil Seal (Garlock 21086 3394)
31	BEA6032	1	Bearing 6032-M-C3
32	DHP-6	1	Drill Head Spindle Sleeve
33	DHP-31-29	1	Drill Head Chain 'P' Head (50 Pins)
34	DHP-2-29	1	Drill Head Hollow Sprocket
35	BEA6213C3E	2	Bearing NSK 6213C3E
36	DH-21	1	Drill Head To Transmission Adaptor
37	OSEAL473243	1	Drill Head To Transmission Oil Seal 473243
38	LW916	4	Lock Washer 9/16"
39	HHCS916C212	4	Hex Cap Screw Ø9/16" UNC x 2 1/2"
40	TR	1	Funk Transmission (SEE FIGURE 2.8)
41	ORING2-254	2	O-Ring 2-254
42	CHKP-M	1	Mirow 'P' Chuck Assembly (SEE FIGURE 2.10)
43	ORING2-278	1	O-Ring 2-278
44	BEA7230	2	Thrust Bearing 7230-B-MP-UA
45	DHP-16M	1	Drill Head Upper Spindle Retaining Ring (For Mirow 'P' Chuck) c/w WH-800 & ORING2-278
46	Z18	2	HYD Grease Fitting Ø1/8" NPT
47	DHP-38M	1	Drill Head Upper Spindle Seal Bushing (For Mirow 'P' Chuck)
48	OSEAL210863492	2	Drill Head Upper Spindle Oil Seal (Garlock 21086 3492)
49	WH-800	1	Internal Spiral Ring
50	DHP-3M	1	Drill Head Spindle Tube For Mirow 'P' Chuck
51	DH-4	2	Drill Head Spindle Tube Key (For DHP-2-29 - Sprocket)
52	SHCS58C412	12	Socket Head Cap Screw Ø5/8" UNC x 4 1/2"
53	DHP-43	1	'N' Rod Adaptor For 'P' Head
54	DHP-44	1	'B' Rod Adaptor For 'P' Head
55	DHP-45	1	'H' Rod Adaptor For 'P' Head
56	CHKP-28	3	Mirow 'P' Chuck Key
57	CHKP-29	1	Mirow 'P' Chuck Key Locking Spring